

Pneumatic Phoenix: Gaining Access to the Filter Elements

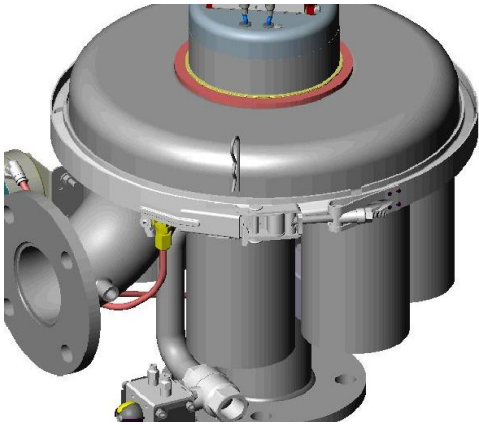

Remove safety clip from ring clamp and place in safe area.

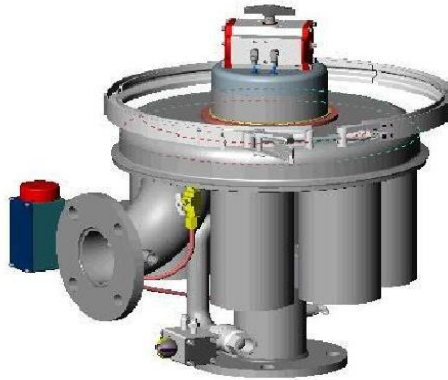

Remove ring clamp by opening handle and releasing catch.

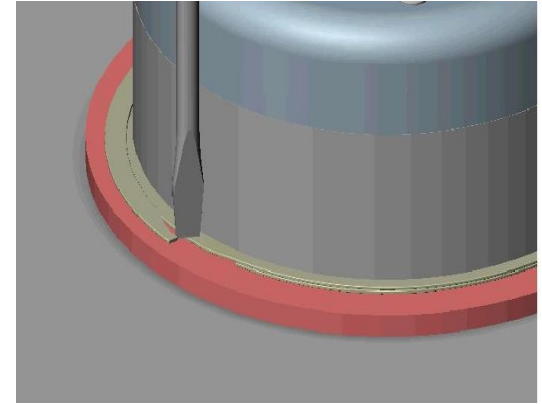

Insert flat screwdriver into tab of split retaining ring and twist. Gently lift upwards, unwinding ring from its groove.

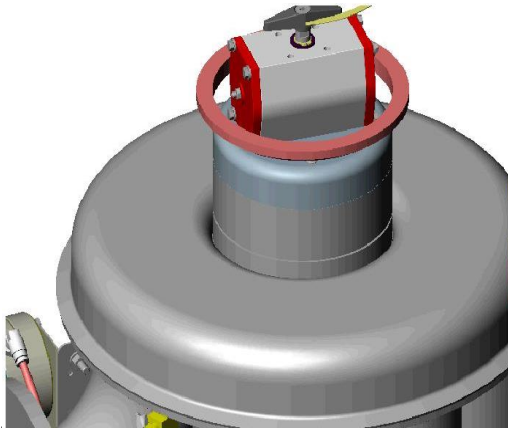

Remove red backing ring by lifting upwards.

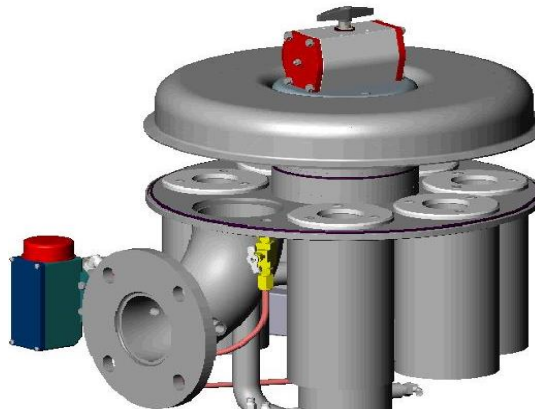

Remove doughnut cover by inserting broad flat screwdriver and gently levering upwards. Once suction is broken, lift cover upwards.

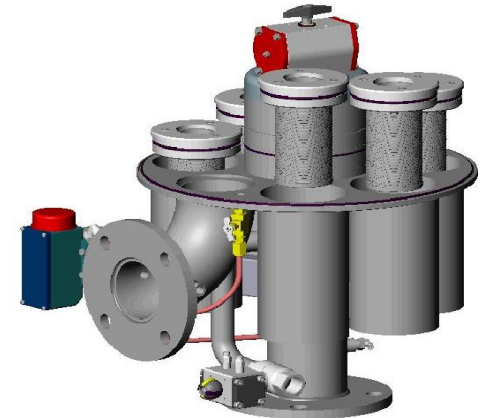

The filter elements are now visible. Remove each filter element by lifting upwards.

Removing Indexing Valve

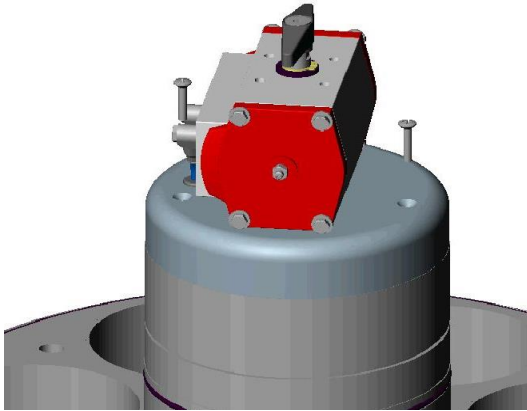

Remove two M4 screws on top of control cover. Note position of cover to filter body.

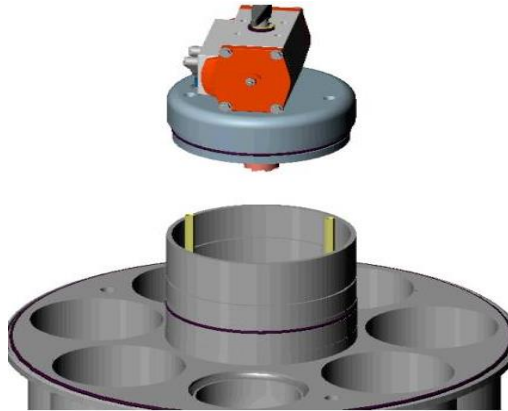

Remove control cover by lifting upwards, being careful of pneumatic airlines connected to cover.

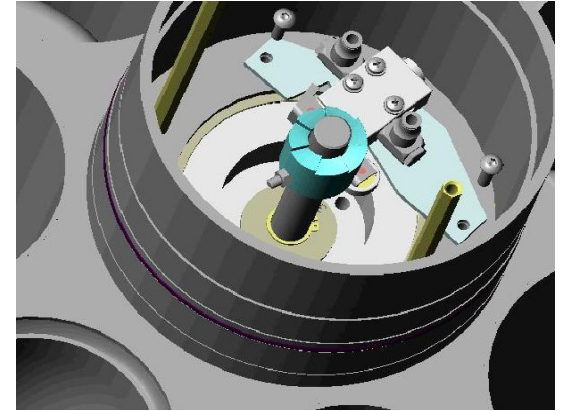

Remove either roller valve or proximity switch by removing two M4 screws holding base plate to Phoenix body.

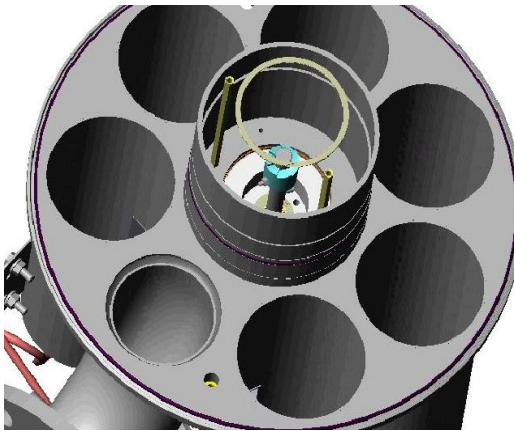

Remove valve retaining ring by inserting screwdriver into tab, twisting, and unwinding from its groove.

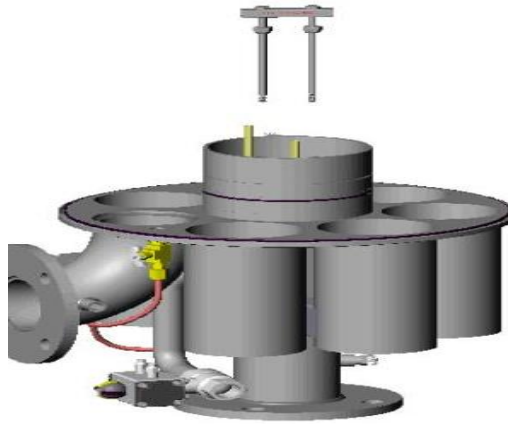

Screw valve puller (part number 9099-000) into valve body and lift upwards.

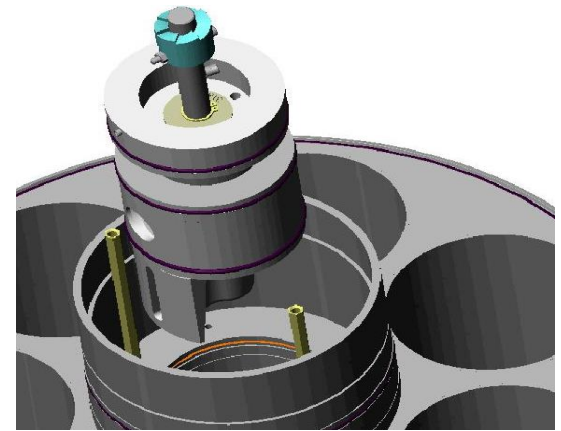

The valve can now be removed from Phoenix.